

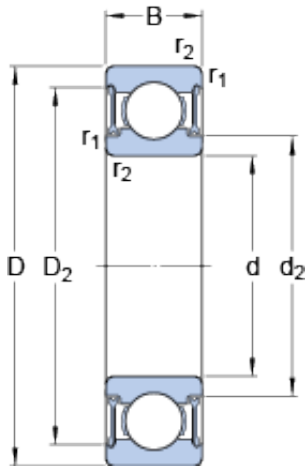

BEARING CORP. OF AMERICA



10 mm x 22 mm x 6 mm skf W 61900-2RZ Deep groove ball bearings

Bearing No. W 61900-2RZ

W 61900-2RZ Bearing 2D drawings and 3D CAD models

Size	22x10x6 mm
Bore Diameter	22 mm
Outer Diameter	10 mm
Width	6 mm
d	10 mm
D	22 mm
B	6 mm
d ₂	13.2 mm
D ₂	19.37 mm
r _{1,2} - min.	0.3 mm
D _a - max.	20 mm
r _a - max.	0.3 mm
Basic dynamic load rating - C	2.3 kN
Basic static load rating - C ₀	1.2 kN
Fatigue load limit - P _u	0.054 kN
Reference speed	70000 r/min
Limiting speed	36000 r/min
Calculation factor - k _r	0.025
Calculation factor - f ₀	14
d ₂	13.2 mm
D ₂	19.4 mm
r _{1,2} min.	0.3 mm
d _a min.	12 mm
d _a max.	13 mm



BEARING CORP.OF AMERICA

D_a max.	20 mm
r_a max.	0.3 mm
Basic dynamic load rating C	2.34 kN
Basic static load rating C_0	1.25 kN
Fatigue load limit P_u	0.054 kN
Calculation factor k_r	0.025
Calculation factor f_0	14
Mass bearing	0.0093 kg