

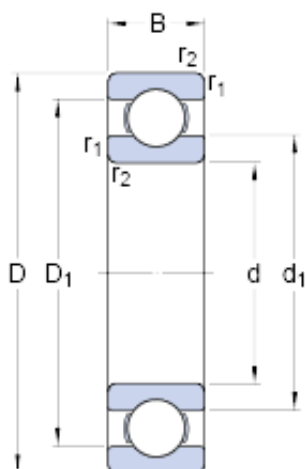

# BEARING CORP.OF AMERICA



850 mm x 1220 mm x 165 mm skf 60/850 MB  
Deep groove ball bearings

Bearing No. 60/850 MB

60/850 MB Bearing 2D drawings and 3D CAD models

Size	1220x850x165 mm
Bore Diameter	1220 mm
Outer Diameter	850 mm
Width	165 mm
d	850 mm
D	1220 mm
B	165 mm
d <sub>1</sub>	974 mm
D <sub>1</sub>	1096 mm
r <sub>1,2</sub> - min.	7.5 mm
d <sub>a</sub> - min.	878 mm
D <sub>a</sub> - max.	1192 mm
r <sub>a</sub> - max.	6 mm
Basic dynamic load rating - C	1120 kN
Basic static load rating - C <sub>0</sub>	2900 kN
Fatigue load limit - P <sub>u</sub>	38 kN
Reference speed	800 r/min
Limiting speed	670 r/min
Calculation factor - k <sub>r</sub>	0.025
Calculation factor - f <sub>0</sub>	16
d <sub>1</sub>	974 mm
D <sub>1</sub>	1096 mm
r <sub>1,2</sub> min.	7.5 mm
d <sub>a</sub> min.	878 mm



## BEARING CORP.OF AMERICA

$D_a$ max.	1192 mm
$r_a$ max.	6 mm
Basic dynamic load rating C	1120 kN
Basic static load rating $C_0$	2900 kN
Fatigue load limit $P_u$	38 kN
Calculation factor $k_r$	0.025
Calculation factor $f_0$	16.4
Mass bearing	630 kg