

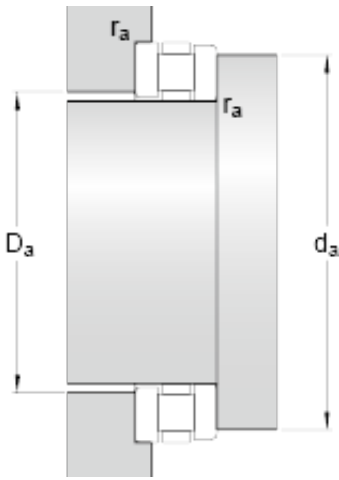

# BEARING CORP.OF AMERICA



891/900 M Bearing 2D drawings and 3D CAD models

900 mm x 1060 mm x 26.5 mm skf 891/900 M  
Cylindrical roller thrust bearings

Bearing No. 891/900 M

d	900 mm
D	1060 mm
H	95 mm
d <sub>1</sub>	1055 mm
D <sub>1</sub>	905 mm
B	26.5 mm
r <sub>1,2</sub> min.	5 mm
d <sub>a</sub> min.	1022 mm
D <sub>a</sub> max.	938 mm
r <sub>a</sub> max.	4 mm
Basic dynamic load rating C	3050 kN
Basic static load rating C <sub>0</sub>	22000 kN
Fatigue load limit P <sub>u</sub>	1250 kN
Reference speed	170 r/min
Limiting speed	340 r/min
Minimum axial load factor A	39
Mass bearing	150 kg