

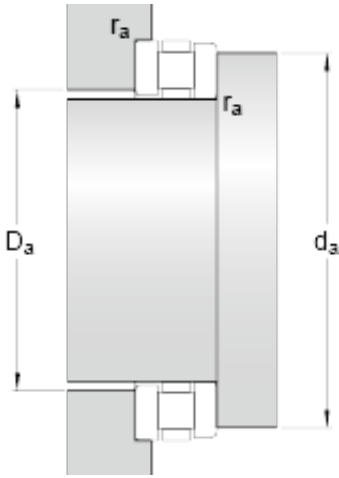

BEARING CORP.OF AMERICA



812/950 M Bearing 2D drawings and 3D CAD models

950 mm x 1250 mm x 68 mm skf 812/950 M Cylindrical roller thrust bearings

Bearing No. 812/950 M

d	950 mm
D	1250 mm
H	236 mm
d ₁	1240 mm
D ₁	960 mm
B	68 mm
r _{1,2} min.	7.5 mm
d _a min.	1200 mm
D _a max.	1000 mm
r _a max.	6 mm
Basic dynamic load rating C	10000 kN
Basic static load rating C ₀	58500 kN
Fatigue load limit P _u	3150 kN
Reference speed	90 r/min
Limiting speed	180 r/min
Minimum axial load factor A	270
Mass bearing	805 kg