

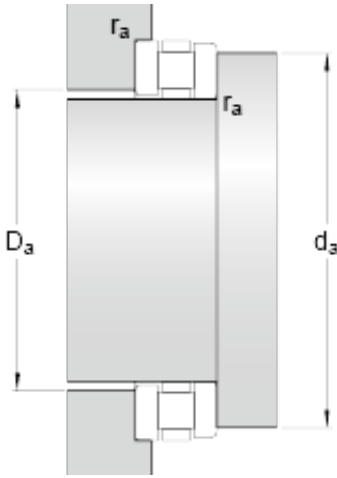

# BEARING CORP.OF AMERICA



460 mm x 560 mm x 24 mm skf 81192 M  
Cylindrical roller thrust bearings

Bearing No. 81192 M

81192 M Bearing 2D drawings and 3D CAD models

|   |           |
|---|-----------|
| d                                       | 460 mm    |
| D                                       | 560 mm    |
| H                                       | 80 mm     |
| d <sub>1</sub>                          | 555 mm    |
| D <sub>1</sub>                          | 464 mm    |
| B                                       | 24 mm     |
| r <sub>1,2</sub> min.                   | 2.1 mm    |
| d <sub>a</sub> min.                     | 553 mm    |
| D <sub>a</sub> max.                     | 479 mm    |
| r <sub>a</sub> max.                     | 2 mm      |
| Basic dynamic load rating C             | 1460 kN   |
| Basic static load rating C <sub>0</sub> | 8500 kN   |
| Fatigue load limit P <sub>u</sub>       | 570 kN    |
| Reference speed                         | 300 r/min |
| Limiting speed                          | 600 r/min |
| Minimum axial load factor A             | 5.8       |
| Mass bearing                            | 41 kg     |