

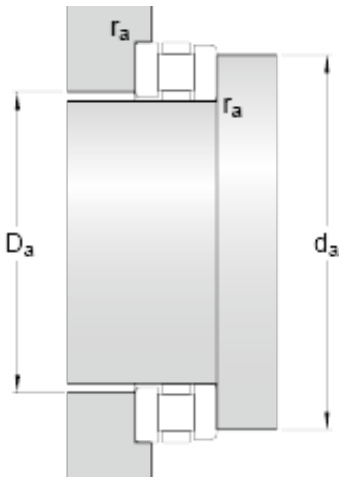

BEARING CORP.OF AMERICA



1120 mm x 1320 mm x 48 mm skf 811/1120 M
Cylindrical roller thrust bearings

Bearing No. 811/1120 M

811/1120 M Bearing 2D drawings and 3D CAD models

d	1120 mm
D	1320 mm
H	160 mm
d ₁	1314 mm
D ₁	1126 mm
B	48 mm
r _{1,2} min.	5 mm
d _a min.	1284 mm
D _a max.	1156 mm
r _a max.	4 mm
Basic dynamic load rating C	6000 kN
Basic static load rating C ₀	41500 kN
Fatigue load limit P _u	2160 kN
Reference speed	110 r/min
Limiting speed	220 r/min
Minimum axial load factor A	140
Mass bearing	410 kg