

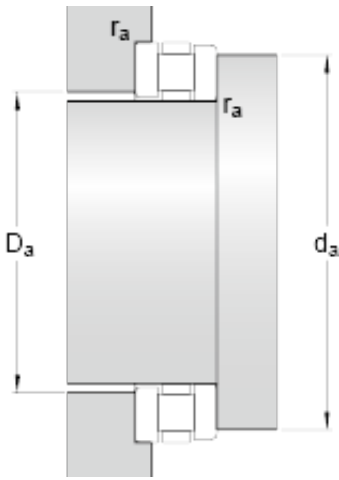

# BEARING CORP.OF AMERICA



480 mm x 650 mm x 39.5 mm skf 81296 M  
Cylindrical roller thrust bearings

Bearing No. 81296 M

d	480 mm
D	650 mm
H	135 mm
d <sub>1</sub>	645 mm
D <sub>1</sub>	485 mm
B	39.5 mm
r <sub>1,2</sub> min.	5 mm
d <sub>a</sub> min.	641 mm
D <sub>a</sub> max.	520 mm
r <sub>a</sub> max.	4 mm
Basic dynamic load rating C	3350 kN
Basic static load rating C <sub>0</sub>	17000 kN
Fatigue load limit P <sub>u</sub>	1100 kN
Reference speed	200 r/min
Limiting speed	400 r/min
Minimum axial load factor A	23.12
Mass bearing	128 kg

81296 M Bearing 2D drawings and 3D CAD models