

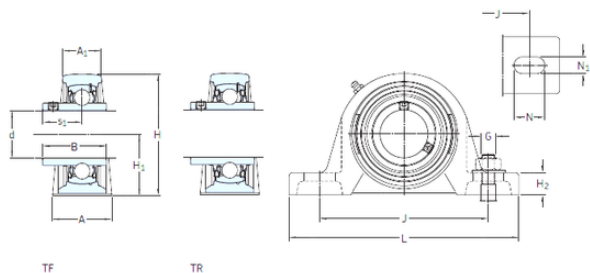

# BEARING CORP.OF AMERICA



## skf SYJ 1.1/2 TF Ball bearing plummer block units

Bearing No. SYJ 1.1/2 TF

SYJ 1.1/2 TF Bearing 2D drawings and 3D CAD models

|                               |           |
|-------------------------------|-----------|
| Bore Diameter                 | 38,1 mm   |
| d                             | 38,1 mm   |
| s1                            | 30,2 mm   |
| A                             | 49 mm     |
| A1                            | 31 mm     |
| B                             | 49,2 mm   |
| G                             | 14 mm     |
| H                             | 99 mm     |
| H1                            | 49,2 mm   |
| H2                            | 18 mm     |
| J                             | 136,5 mm  |
| L                             | 184 mm    |
| N                             | 25,5 mm   |
| N1                            | 17 mm     |
| Weight                        | 1,9 Kg    |
| Basic dynamic load rating (C) | 30,7 kN   |
| Basic static load rating (C0) | 19 kN     |
| Fatigue load limit (Pu)       | 0,8       |
| Housing material              | Cast iron |
| A <sub>1</sub>                | 31 mm     |
| B <sub>4</sub>                | 8 mm      |
| H <sub>1</sub>                | 49.2 mm   |
| H <sub>2</sub>                | 18 mm     |
| J max.                        | 145 mm    |
| J min.                        | 128 mm    |



## BEARING CORP.OF AMERICA

|   |               |
|---|---------------|
| $N_1$   | 17 mm         |
| $s_1$   | 30.2 mm       |
| $R_G$   | 1/4-28 UNF    |
| $R_1$   | 3.5 mm        |
| R   | 45 °          |
| $D_N$   | 6.5 mm        |
| $SW_N$  | 7 mm          |
| $G_N$   | 1/4-28 SAE-LT |
| $J_6$   | 170 mm        |
| $J_7$   | 17.5 mm       |
| $N_4$   | 4 mm          |
| Basic dynamic load rating C                       | 30.7 kN       |
| Basic static load rating $C_0$                    | 19 kN         |
| Fatigue load limit $P_u$                          | 0.8 kN        |
| Limiting speed                                    | 4800 r/min    |
| Mass bearing unit                                 | 1.85 kg       |
| Thread grub screw $G_2$                           | 5/16-24 UNF   |
| Hexagonal key size for grub screw N               | 3.969 mm      |
| Recommended tightening torque for grub screw      | 6.5 N · m     |
| Recommended diameter for attachment bolts, mm G   | 14 mm         |
| Recommended diameter for attachment bolts, inch G | 0.5625 in     |