

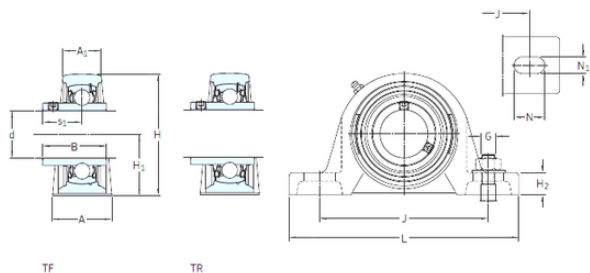

BEARING CORP.OF AMERICA



skf SY 1.7/16 TF Ball bearing plummer block units

Bearing No. SY 1.7/16 TF

SY 1.7/16 TF Bearing 2D drawings and 3D CAD models

Bore Diameter	36,513 mm
d	36,513 mm
s1	25,4 mm
A	45 mm
A1	27 mm
B	42,9 mm
G	12 mm
H	93 mm
H1	47,6 mm
H2	19 mm
J	126 mm
L	160 mm
N	21 mm
N1	14 mm
Weight	1,6 Kg
Basic dynamic load rating (C)	25,5 kN
Basic static load rating (C0)	15,3 kN
Fatigue load limit (Pu)	0,655
Category	Pillow Block Bearings
Inventory	0.0
Manufacturer Name	SKF
Minimum Buy Quantity	N/A
Weight / Kilogram	1.54
EAN	7316577747914
Product Group	M06110



BEARING CORP.OF AMERICA

Number of Mounting Holes	2
Mounting Method	Set Screw
Housing Style	2 Bolt Pillow Block
Rolling Element	Ball Bearing
Housing Material	Cast Iron
Expansion / Non-expansion	Non-expansion
Mounting Bolts	1/2 Inch
Relubricatable	Yes
Insert Part Number	YAR 207-107-2F
Seals	M Seal
Housing Configuration	1 Piece Solid
Inch - Metric	Inch
Other Features	Single Row Standard Duty Wide Inner Race Y Bearing Has Flinger
Long Description	2 Bolt Pillow Block; 1-7/16" Bore; 1-7/8" Base to Center Height; Set Screw Mount; Ball Bearing; 4-11/16" Minimum Bolt Spacing; 5-1/4" Bolt Spacing Maximum; Relubricatable; Cast Iro
Category	Pillow Block
UNSPSC	31171511
Harmonized Tariff Code	8483.20.40.40
Noun	Bearing
Keyword String	Pillow Block
Manufacturer URL	http://www.skf.com
Manufacturer Item Number	SY 1.7/16 TF
Weight / LBS	3.4
Length Thru Bore	1.688 Inch 42.87 Millimeter
Bolt Spacing Maximum	5.25 Inch 133.35Millimeter
Nominal Bolt Center to Center	5 Inch 127 Millimeter



BEARING CORP.OF AMERICA

Bore	1.438 Inch 36.525 Millimeter
Actual Bolt Center to Center	0 Inch 0Millimeter
Bolt Spacing Minimum	4.688 Inch 119.075Millimeter
Base to Center Height	1.875 Inch 47.63 Millimeter
Housing material	Cast iron
A ₁	27 mm
A ₅	24.5 mm
B ₄	6 mm
H ₁	47.6 mm
H ₂	19 mm
J max.	133 mm
J min.	119 mm
N ₁	14 mm
s ₁	25.4 mm
R _G	1/4-28 UNF
R ₁	3 mm
R	45 °
D _N	6.5 mm
SW _N	7 mm
G _N	1/4-28 SAE-LT
J ₆	146 mm
J ₇	15.5 mm
N ₄	4 mm
Basic dynamic load rating C	25.5 kN
Basic static load rating C ₀	15.3 kN
Fatigue load limit P _u	0.655 kN
Limiting speed	5300 r/min
Mass bearing unit	1.5 kg
Thread grub screw G ₂	5/16-24 UNF



BEARING CORP.OF AMERICA

Hexagonal key size for grub screw N	3.969 mm
Recommended tightening torque for grub screw	6.5 N · m
Recommended diameter for attachment bolts, mm G	12 mm
Recommended diameter for attachment bolts, inch G	0.5 in